

## Low pressure overmolding unit

HI 3 B

Low pressure horizontal injection overmolding unit - Basic version - for Hot Melt materials  
Swan neck mold closing press with 3 open sides



## FEATURES

- Steel electro-welded structure
- Possibility to use one upper mold and one lower mold
- Integrated 3 l melting tank
- Electronic injection pressure adjustment from 1 to 50 bar (EPR)
- Mold clamping force 1.2 T
- 2 independent PID temperature control zones  $\pm 2\%$
- Weekly switch-on time programming
- Temperature limits with programmable alarms
- Cycle start bimanual
- Quick mold replacement
- Mold cooling circuit manifold
- Pneumatic ejection system

## OPTIONS

- Chiller CBV 5.1, cooling mold unit with adjustable temperature
- Automatic Feeding System (AFS)
- D 10 Resin Dryer
- Electronic injection pressure adjustment from 1 to 50 bar (EPR) + Mold Area Illumination, led (factory installed)
- Manifold for cooling water system connection
- Machine stand

## TECHNICAL SPECIFICATIONS

	<b>HI 3 B</b>
Mold clamping force	1.2 T
Tank capacity	3 l (optional 7 l)
Temperature control zones	2
Max. tank and gun temperature	250° C
Temperature monitoring	$\pm 1^\circ$ C
Mold stroke	125 mm
Clamping system	Pneumatic cylinder
Control system	Touch screen 7" HMI and PLC
Safety protection	Sliding frontal door
Air supply	6 bar, 0.18m <sup>3</sup> /cycle
Power supply	220VAC 1P+N+G 50/60 Hz 4,5 kW
Dimensions and Weight	750 x 1050 x 1000 mm / 250 kg

**CE Conformity:** HI 3 B is fully compliant with CE regulations and EMC equipment guidelines for mechanical, electrical and electromagnetic compatibility.

**Note:** we recommend to send samples with the application requirements for a preliminary examination.

The unit works with Technomelt, Thermelt and Macromelt resins and Hot Melt polyamide and polyolefin resins.

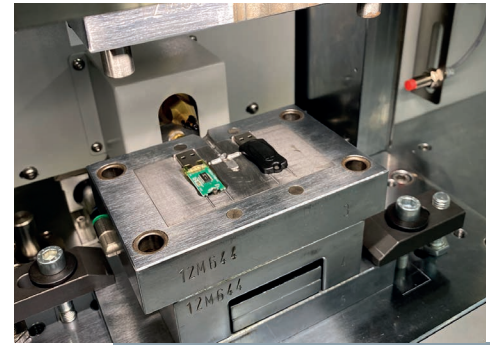

**Horizontal injection mold**



## MOLD DIMENSIONS

FROM 180mm TO 250mm  
FROM 150mm TO 230mm

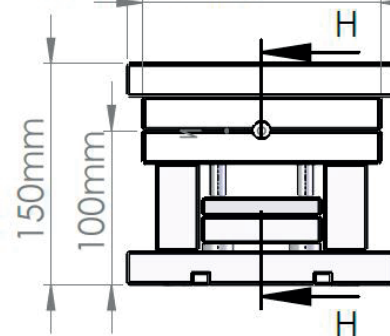

FROM 100mm TO 120mm

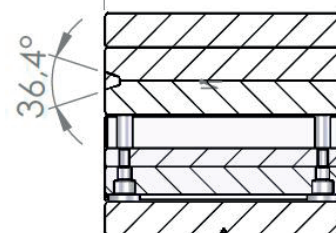

**SECTION H-H**